

Safety Needle Holder *Instructions for Use*

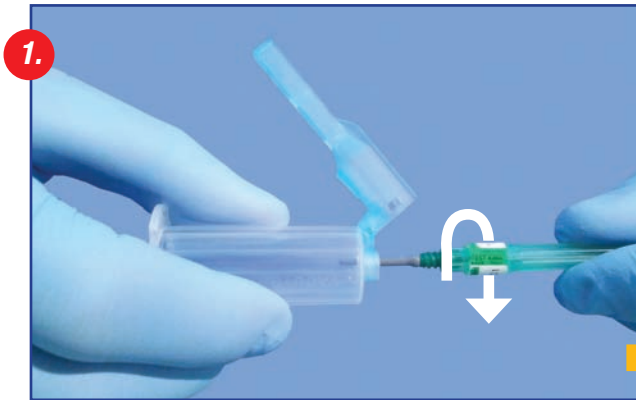

1. Screw the needle completely onto the holder. Remove cap from needle.

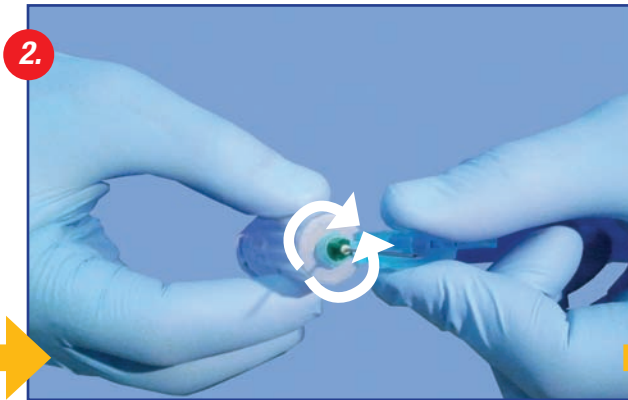

2. The safety shield can be rotated for comfortable blood collection. Simply grasp the end of the shield and rotate.

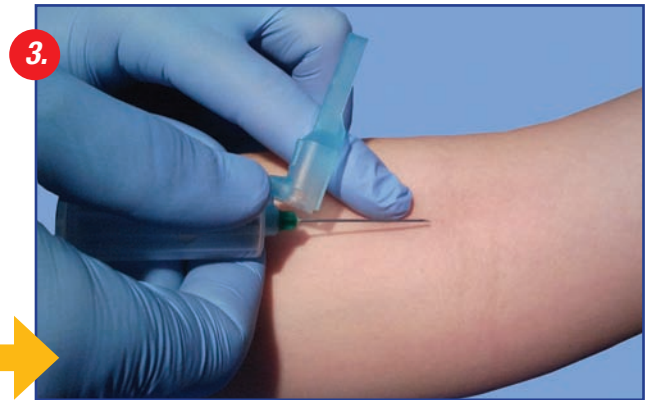

3. Perform blood collection according to established safety procedures.

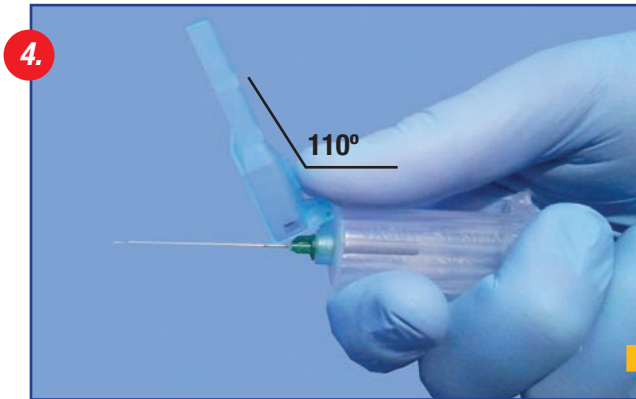

4. Immediately after blood collection, swivel the safety shield over the needle to prepare for closing.

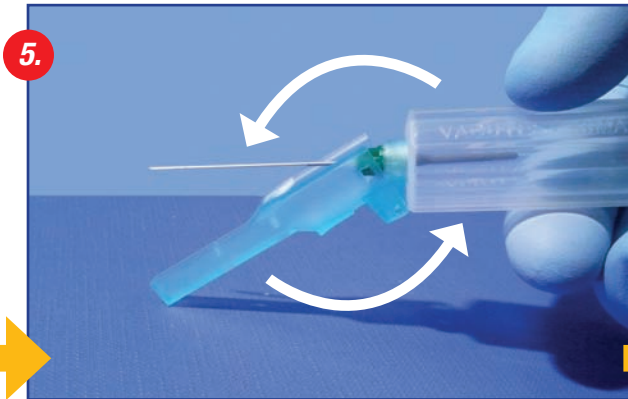

5. Close by pressing the safety shield against a hard surface.

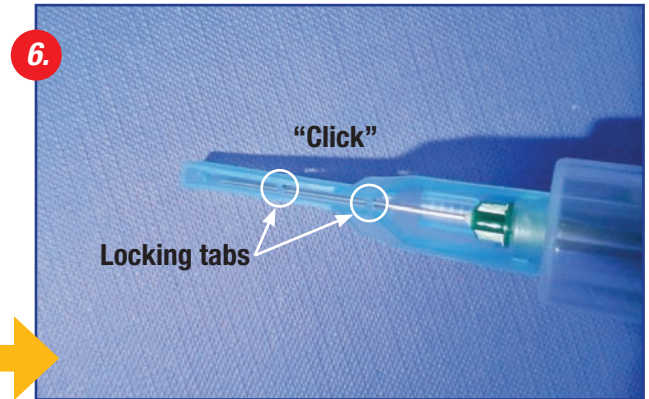

6. When a "click" is heard the needle is secured in place by the locking tabs inside the safety shield.

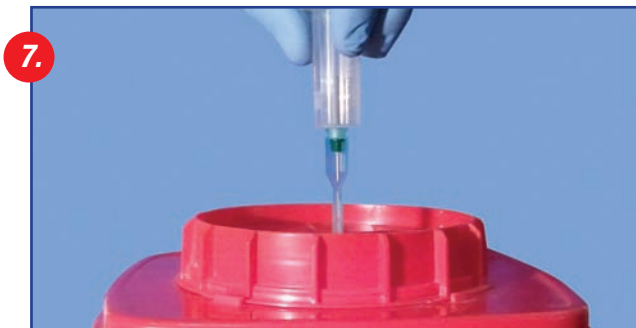

7. Dispose of the blood collection device into a Sharps container. **NEVER reuse the device after initial use.**

- Complies with OSHA directives by preventing removal of needle and re-use of holder
- Fits both 13mm and 16mm blood collection tubes and all common needle units

Item#	Description	Packaging
1204	Safety Needle Holder	5 x 100/case
1205	Safety Needle Holder	100/case

globe[®]
SCIENTIFIC INC.

www.globescientific.com

Globe Scientific Inc.

610 Winters Avenue • Paramus, NJ 07652 • USA

Customer service, sales and technical support:

Phone 1 (800) 394-4562 • 1 (201) 599-1400

Fax 1 (201) 599-1406

E-mail mail@globescientific.com

© Copyright 2012 Globe Scientific Inc. All rights reserved. 1204INS 12314